

REPLACEMENT FOIL HEAD AND CUTTER FOR SINGLE FOIL SHAVER FOILFX01

Includes:

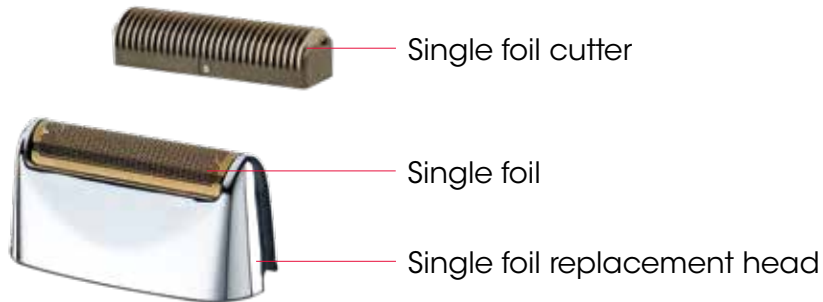

Instructions for use

- Turn shaver to the OFF position. Press the foil head release button on the side of the shaver. The foil head should easily pull away from the body of the shaver.

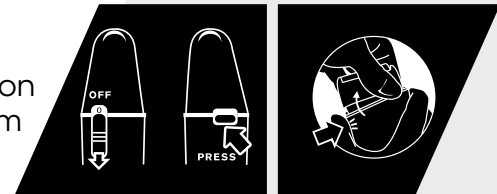

- Remove the used foil cutter. Hold the foil shaver with one hand; with your other hand hold the old cutter by the two ends and lightly pull up and away from the foil body. Cutter should be easily removable.



- Remove new foil cutter from the package. Line up the cutter guide with the drive shaft and press down lightly until you hear it click into place.



- Remove the new foil head from the package. Place new replacement foil head assembly directly onto the foil body. Lightly press down until you hear the new replacement foil head assembly click into place. Turn on foil shaver and make sure it is working properly.



BaByliss^{PRO}
Artists

Innovative premium technology

www.babylisspro.com

FXRF1E

Barcode 3030050157635